

# Concerto Arm Assembly Instructions

## Table of Parts

Part	Description
A	Pole Cap Screw
B	Pole Cap
C	Monitor Mount Knuckle
D	Pole Joint Bushing
E	Arm Support Ring
F	Pole Assembly
G	Clamping Screw
H	Clamp Assembly
I	Grommet Mount Plate
J	Grommet Mount Bolt
K	Rigid Hub Spindle & Screw
L	Upper/Lower Joint bushing
M	Arm Joint Bushing
N	Arm Segment
O	Rigid Hub Shaft
P	Beam Arm Shaft
Q	Beam End Cap
R	Beam Assembly
S	Hub Bushing Half
T	Beam Cable Manager
U	Beam Screw
V	Beam Lock Nut
W	Trim Ring
X	Wall Bracket
Y	Slat Wall Bracket
Z	Joint Cable Manager
AA	Arm Set Screw
AB	Keyboard Arm Assembly
AC	Pole Wall Mount Assembly

## Beam Mounted Models

1. Mount pole (F) to work surface using either the clamp or grommet (see reverse).
2. Assemble beam support ring (E) to pole at desired height.
3. Attach beam assembly (R) to pole at desired height.
4. Assemble cap (B) to pole tighten using screw (A) and 3/16" Allen key.
5. Mount monitors to Knuckles (C).
6. Mount monitor assemblies to extension arms as shown (if applicable) (2x)
7. Slide monitor assemblies into "T" slot on top of beam using beam mounting hardware.(P)
8. Slide cable managers (T) into "T" slot on backside of beam.
9. Assemble beam end caps (Q).
10. Adjust monitor locations as desired and secure using 3/16" Allen key.
11. Insert monitor cables through cable managers.

## Mounting Arm Assemblies to a Slat Wall using The Slat-Wall Mounting System:

1. Hook the top hooks of the slat-wall bracket (Y) into the slat-wall at the desired height.
  2. Place the lower hooks into the lowest slot in the slat-wall within the range of the hook.
  3. Push upward on the lower hooks making sure all hooks are well seated.
  4. Tighten the 4 bolts securely. Ensure the bracket is tight and secure to the slat wall.
  5. Mount monitor to knuckle (C).
  6. Slide monitor assembly into "T" slot on top of beam.
  7. Assemble beam end caps. (Q)
- NOTE: It is the responsibility of the installer to ensure proper anchoring of the slat-wall mount bracket.**

## Wall Mounted Models

1. Assemble support ring (E) to pole at desired height. Snap bushing (D) into Keyboard Arm Assembly.
2. Mount Keyboard Arm assembly (AB) to pole and tighten set screw to secure, followed by trim ring (W).
3. Assemble support ring (E) to pole at desired height. Snap bushing (D) into knuckle (C).
4. Mount Monitor Assembly to pole and set to correct height, followed by trim ring (W).
5. Secure Pole Wall Mount Assemblies (AC) to Pole.
6. Mount Pole to wall using wall mount brackets.
7. Mount monitor to monitor mount assembly.

## Mounting Arm Assemblies to a Wall using The Wall Mounting System:

1. mount wall bracket (X) to wall using appropriate fastening hardware (not included) considering wall type, arm extension and monitor weight.
  2. Mount monitor to knuckle.
  3. Slide monitor assembly into "T" slot on top of beam using beam mounting hardware. (P)
  4. Assemble beam end caps. (Q)
- NOTE: It is the responsibility of the installer to ensure proper anchoring of the wall mount bracket.**

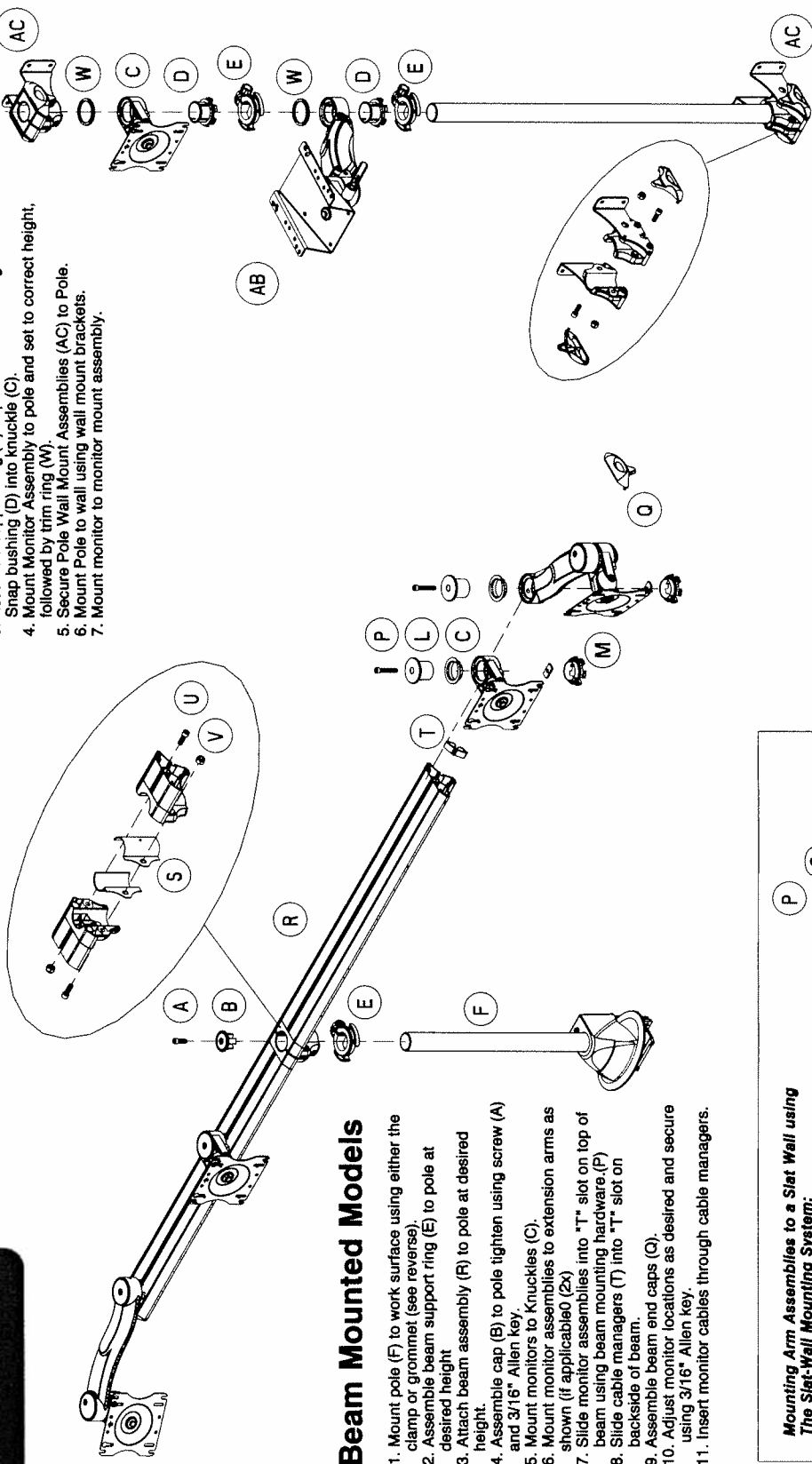

# Concerto Arm Assembly Instructions

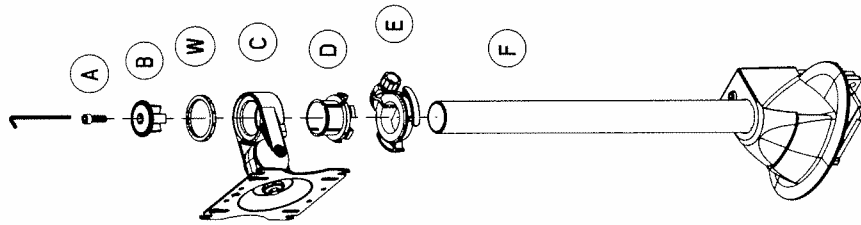

## Base Models

1. Mount pole (F) to work surface using either the clamp or grommet (see below).
2. Mount monitor onto knuckle (C).
3. Assemble support ring (E) to pole at desired height. Snap bushing (D) into knuckle (C).
4. Mount monitor assembly to pole (set to correct height) followed by trim ring (W).
5. Assemble cap (B) to pole using screw (A) and 3/16" Allen key.

### Mounting pole to work surface using the Clamp Mounting System:

1. Loosen screw (G) with 3/16" Allen Key.
2. Fit clamp base (H) onto work surface in desired location. Vertical steel plate should contact edge of desk.
3. Tighten screw (G) using 3/16" Allen key.

### Mounting pole to work surface using the Grommet Mounting System:

1. Loosen bolt (J) using 3/16" Allen Key. Have grommet components ready.
2. Lay monitor cables down through hole in work surface.
3. Place pole assembly over hole in work surface.
4. Assemble grommet parts, tighten bolt (J).

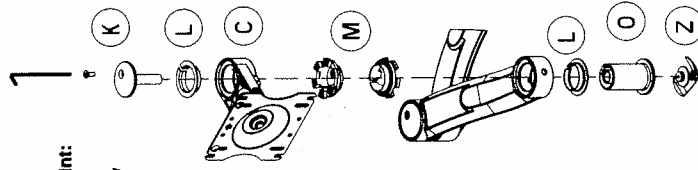

### To disassemble Rigid Hub Joint:

1. Remove cable manager (K).
2. Remove socket head cap screw using Allen Key

## Extension Models

1. Mount pole (F) to work surface using either the clamp or grommet (see below).
2. Mount monitor onto knuckle (C).
3. Mount monitor assembly to extension arm (N)
4. Assemble support ring (E) to pole at desired height, snap bushing (D) into extension arm (N).
5. Mount arm assembly to pole (set to correct height) and tighten set screw (AA) to secure, followed by trim ring (W).
6. Assemble cap (B) to pole using screw (A) and 3/16" Allen key.
7. For additional screens repeat steps 2 to 6.
8. Insert monitor cables through cable managers.
9. Assemble cable managers to bottom of all joints (O).

### Adjusting the Height Adjustable Segment:

1. With the monitor mounted to the arm, move the monitor through the height range; Ensure the arm will hold the monitor in the position you placed it.
2. If the monitor drops or rebounds upward, adjust the tension screw at the back of the arm segment as shown using the 3/16" Allen key. Repeat steps until the monitor is well counterbalanced.